

## GENERAL INFORMATION

### LAMINATED DUCTING

#### DEC INTERNATIONAL, producer of flexible ducting for air management systems and heating systems (HVAC)

The abbreviation '**DEC**' stands for **Dutch Environment Corporation bv**, trading its products under the name **DEC International**, is established in Enschede (The Netherlands) with a facility for the production and distribution of flexible ducting. Over the years **DEC** has become one of the world's largest manufacturers of flexible ducting systems and is recognized globally for its superior quality, its machine engineering and services.

The production process is certified according to **ISO9001:2008**.

#### DEC INTERNATIONAL'S SPECIAL DUCT CONSTRUCTIONS

The DEC-laminate has been constructed out of a "sandwich construction".  
The polyester layer and the aluminium foil are shifted with respect to each other.

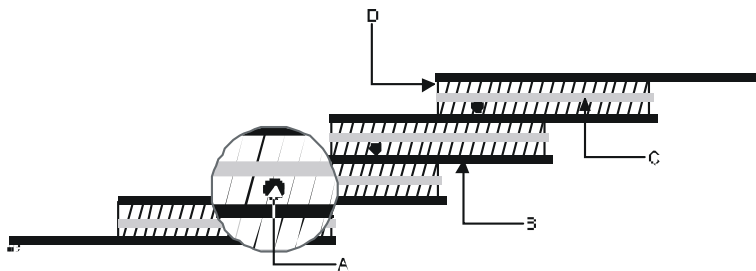

- A. wire
- B. polyester layer
- C. aluminium foil
- D. adhesion

#### PURE METAL DUCTS

The normal pure metal ducts have been produced with a folded seam.

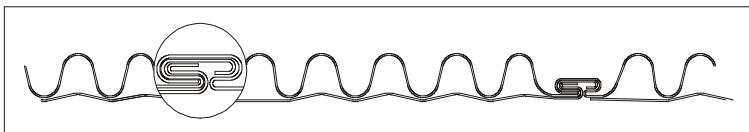
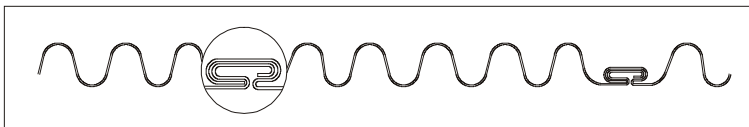

**DEC International**, however, has produced a few products more solid. This means that these connections have a double folded seam. This connection is used in products like the Flueliners.

#### LIABILITY:

The information contained in this brochure was current on the publication date. DEC INTERNATIONAL reserves the right to make changes in details at any time without prior notice. In order to avoid misunderstandings, any interested party is advised to contact DEC INTERNATIONAL checking for any changes in materials and/or information after this brochure was published.

#### PLEASE NOTICE:

The consultant is responsible for the actual installation and mounting of the product. The mentioned values with respect to temperatures are not appropriate to be used to determine the physical properties. These properties are also dependent on humidity and the temperature of the air inside and outside of the H.V.A.C. system.

#### TRADEMARKS:

The DEC logo and DEC International are trademarks, or registered trademarks of Dutch Environment Corporation BV in the Netherlands and/or other countries.

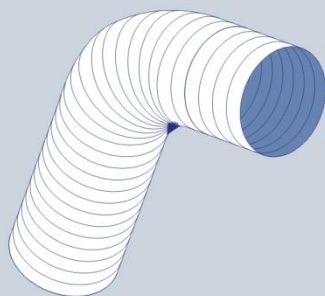

## GENERAL INFORMATION

### LAMINATED DUCTING

#### OPTIONS IN RESPECT TO HOUSE CONSTRUCTION

Application	Product	Properties
Mechanical exhausting	<ul style="list-style-type: none"> <li>Aludec</li> <li>Combidec</li> <li>Greydec</li> </ul>	<ul style="list-style-type: none"> <li>up to 250 °C</li> <li>up to 140 °C</li> <li>up to 70 °C</li> <li>different chemical resistance</li> </ul>
Air heating	<ul style="list-style-type: none"> <li>Isodec</li> <li>Sonodec</li> </ul>	<ul style="list-style-type: none"> <li>T insulated</li> <li>T + A insulated</li> </ul>
Toilet exhausting	<ul style="list-style-type: none"> <li>Aludec</li> <li>Greydec</li> </ul>	<ul style="list-style-type: none"> <li>up to 250 °C</li> <li>up to 70 °C</li> </ul>
Mechanical ventilation	<ul style="list-style-type: none"> <li>Aludec</li> <li>Combidec</li> </ul>	<ul style="list-style-type: none"> <li>very flexible</li> <li>very flexible</li> </ul>
Removing noise machines	<ul style="list-style-type: none"> <li>Sonodec</li> </ul>	<ul style="list-style-type: none"> <li>fire resistance tested</li> </ul>
Combustion tube	<ul style="list-style-type: none"> <li>Decflex Flueliner</li> </ul>	<ul style="list-style-type: none"> <li>smooth inside</li> </ul>
Chimney lining	<ul style="list-style-type: none"> <li>Decflex Flueliner</li> </ul>	<ul style="list-style-type: none"> <li>combustion gas resistant</li> <li>air supply</li> </ul>
Insertion loss	<ul style="list-style-type: none"> <li>Sonodec TRD</li> </ul>	<ul style="list-style-type: none"> <li>attenuation in flow direction</li> </ul>
Sound attenuation duct wall	<ul style="list-style-type: none"> <li>Sonodec GLX</li> </ul>	<ul style="list-style-type: none"> <li>increased attenuation duct wall</li> </ul>
Insulation of existing channels	<ul style="list-style-type: none"> <li>Isosleeve</li> </ul>	<ul style="list-style-type: none"> <li>insulation jacket to attach easily</li> </ul>

#### OPTIONS IN RESPECT TO BUILDING OF PUBLIC UTILITIES

Application	Product	Properties
Cooled air	<ul style="list-style-type: none"> <li>Isodec</li> <li>Sonodec</li> </ul>	<ul style="list-style-type: none"> <li>T insulated</li> <li>T+A insulated</li> </ul>
Mechanical exhausting	<ul style="list-style-type: none"> <li>Aludec</li> <li>Combidec</li> <li>Greydec</li> </ul>	<ul style="list-style-type: none"> <li>up to 250 °C</li> <li>up to 140 °C</li> <li>up to 70 °C</li> <li>diff.chem.res.</li> </ul>
Air heating	<ul style="list-style-type: none"> <li>Isodec</li> <li>Sonodec</li> </ul>	<ul style="list-style-type: none"> <li>T insulated</li> <li>T+A insulated</li> </ul>
Toilet exhausting	<ul style="list-style-type: none"> <li>Aludec</li> <li>Combidec</li> <li>Greydec</li> <li>Stretchdec</li> <li>Compacdec</li> </ul>	<ul style="list-style-type: none"> <li>up to 250 °C, flexible</li> <li>up to 140 °C, flexible</li> <li>up to 70 °C, flexible</li> <li>up to 250 °C, rigid</li> <li>up to 250 °C, rigid</li> </ul>
Mechanical ventilation	<ul style="list-style-type: none"> <li>Aludec</li> <li>Combidec</li> <li>Stretchdec</li> <li>Compacdec</li> </ul>	<ul style="list-style-type: none"> <li>aluminium laminate</li> <li>mechanical strengthened</li> <li>pure aluminium</li> <li>pure aluminium</li> </ul>
Removing noise machines	<ul style="list-style-type: none"> <li>Sonodec</li> </ul>	<ul style="list-style-type: none"> <li>fire resistance tested</li> </ul>
Exhaust- and ventilation duct	<ul style="list-style-type: none"> <li>Combidec</li> <li>Greydec HP</li> </ul>	<ul style="list-style-type: none"> <li>up to 140 °C</li> <li>up to 70 °C</li> <li>different chemical resistance</li> </ul>
Chimney lining	<ul style="list-style-type: none"> <li>Decflex Flueliner</li> </ul>	<ul style="list-style-type: none"> <li>combustion gas resistant</li> <li>air supply purposes</li> </ul>
Decreasing of sound level	<ul style="list-style-type: none"> <li>Sonodec TRD</li> </ul>	<ul style="list-style-type: none"> <li>increased attenuation in flow direction</li> </ul>
Decreasing of noise	<ul style="list-style-type: none"> <li>Sonodec GLX</li> </ul>	<ul style="list-style-type: none"> <li>increased wall attenuation</li> </ul>
Insulation of existing channels	<ul style="list-style-type: none"> <li>Isosleeve</li> </ul>	<ul style="list-style-type: none"> <li>insulation jacket to attach easily</li> </ul>

#### EXPLANATION

T insulated = Thermically insulated

T+A insulated = Thermically and Acoustically insulated

#### LIABILITY:

The information contained in this brochure was current on the publication date. DEC INTERNATIONAL reserves the right to make changes in details at any time without prior notice. In order to avoid misunderstandings, any interested party is advised to contact DEC INTERNATIONAL checking for any changes in materials and/or information after this brochure was published.

#### PLEASE NOTICE:

The consultant is responsible for the actual installation and mounting of the product. The mentioned values with respect to temperatures are not appropriate to be used to determine the physical properties. These properties are also dependent on humidity and the temperature of the air inside and outside of the H.V.A.C. system.

#### TRADEMARKS:

The DEC logo and DEC International are trademarks, or registered trademarks of Dutch Environment Corporation BV in the Netherlands and/or other countries.

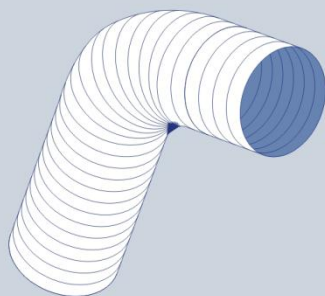

## GENERAL INFORMATION

### LAMINATED DUCTING

#### OPTIONS IN RESPECT TO INDUSTRY AND GENERAL

Application	Product	Properties
Exhaust hose	<ul style="list-style-type: none"> <li>Decflex Fluelineer</li> </ul>	<ul style="list-style-type: none"> <li>smooth inside</li> </ul>
Exhausting welding vapours	<ul style="list-style-type: none"> <li>Combidec</li> </ul>	<ul style="list-style-type: none"> <li>static set up</li> </ul>
Insulation (rain) water discharging	<ul style="list-style-type: none"> <li>Isosleeve</li> </ul>	<ul style="list-style-type: none"> <li>to attach easily</li> </ul>
Air supply general	<ul style="list-style-type: none"> <li>Aludec</li> <li>Compacdec</li> <li>Stretchdec</li> </ul>	<ul style="list-style-type: none"> <li>aluminium laminate</li> <li>pure aluminium</li> <li>pure aluminium</li> </ul>
Air supply higher temperatures	<ul style="list-style-type: none"> <li>Aludec 112</li> </ul>	<ul style="list-style-type: none"> <li>up to 250 °C</li> </ul>
Higher temperature resistance	<ul style="list-style-type: none"> <li>Decflex Fluelineer</li> </ul>	<ul style="list-style-type: none"> <li>smooth inside surface</li> </ul>
Chimney lining	<ul style="list-style-type: none"> <li>Decflex Fluelineer</li> </ul>	<ul style="list-style-type: none"> <li>combustion gas resistant</li> <li>ventilation</li> </ul>
Decreasing of sound	<ul style="list-style-type: none"> <li>Sonodec TRD</li> </ul>	<ul style="list-style-type: none"> <li>increased attenuation in flow direction</li> </ul>
Decreasing of sound	<ul style="list-style-type: none"> <li>Sonodec GLX</li> </ul>	<ul style="list-style-type: none"> <li>increased attenuation in duct wall</li> </ul>
Insulation of existing channels	<ul style="list-style-type: none"> <li>Isosleeve</li> </ul>	<ul style="list-style-type: none"> <li>insulation jacket to attach easily</li> </ul>

#### OPTIONS IN RESPECT TO SPECIAL APPLICATIONS

Application	Product	Properties
Clothes drier	<ul style="list-style-type: none"> <li>PVC</li> </ul>	<ul style="list-style-type: none"> <li>up to 70 °C</li> </ul>
General air supply purposes	<ul style="list-style-type: none"> <li>Aludec</li> </ul>	<ul style="list-style-type: none"> <li>very flexible</li> </ul>
Chimney lining	<ul style="list-style-type: none"> <li>Decflex Fluelineer</li> </ul>	<ul style="list-style-type: none"> <li>combustion gas resistant</li> <li>ventilation</li> </ul>
Decreasing of sound	<ul style="list-style-type: none"> <li>Sonodec TRD</li> </ul>	<ul style="list-style-type: none"> <li>increased attenuation in flow direction</li> </ul>
Decreasing of sound	<ul style="list-style-type: none"> <li>Sonodec GLX</li> </ul>	<ul style="list-style-type: none"> <li>increased attenuation of the duct wall</li> </ul>

#### EXPLANATION

T insulated = Thermically insulated  
T+A insulated = Thermically and acoustically insulated

#### LIABILITY:

The information contained in this brochure was current on the publication date. DEC INTERNATIONAL reserves the right to make changes in details at any time without prior notice. In order to avoid misunderstandings, any interested party is advised to contact DEC INTERNATIONAL checking for any changes in materials and/or information after this brochure was published.

#### PLEASE NOTICE:

The consultant is responsible for the actual installation and mounting of the product. The mentioned values with respect to temperatures are not appropriate to be used to determine the physical properties. These properties are also dependent on humidity and the temperature of the air inside and outside of the H.V.A.C. system.

#### TRADEMARKS:

The DEC logo and DEC International are trademarks, or registered trademarks of Dutch Environment Corporation BV in the Netherlands and/or other countries.